

# Centrifugal pumps

## Dolphin Range

### Sectional Drawing

#### Description

Vertical in-line, single-stage, single/double suction, overhung pumps with rigid coupling, radially split. Option for external bearings/flexible coupling on vertical single suction pumps. Horizontal end suction, single-stage, single suction, overhung pumps close-coupled or base-plated with flexible coupling.

**Capacity:** 20-1400 m<sup>3</sup>/h

**Differential pressure:** 10-130 m.c.

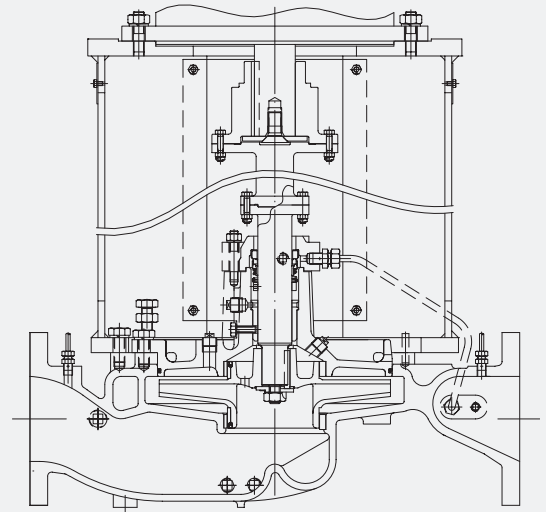

### Technical specification

#### Vertical spacer coupled dimensions

Pump Size	Single and Double Entry, Vertical, Spacer Dismantling, Non-self Primed						
	Flange According to BS4504 PN16		Dimensions (mm) - VID/VIF				Weight* (kg) VID/VIF
	Discharge Flange ND	Suction Flange ND	A	B	C	D	
B080	80	80	580	133	717/876	580	217/286
C080	80	80	640	131	717/876	660	248/318
B125	125	125	640	134	743/923	580	248/320
C125	125	125	720	134	743/923	660	295/360
D125	100	125	760	147	743/923	710	353/424
B200	200	200	760	183	854/1049	710	349/411
C200	200	200	800	183	854/1049	710	370/437
B250	250	250	800	200	1066	330	403
B300	300	300	900	250	1162	327	506
B350	350	350	1040	260	1323	390	832

\*Approximate Weight (excluding motor)

#### Horizontal close coupled dimensions

Pump Size	Single Entry, Horizontal, End Suction, Non-self Primed							
	Flange According to BS4504 PN16		Dimensions (mm) - Min/Max Motor					Weight* (kg)
	Discharge Flange ND	Suction Flange ND	A	B	C	D	E	
B080	80	80	230/290	400/530	500/590	280	290	110/123
C080	82	80	230/290	530	590	300	320	122/126
B125	125	125	230/290	440/530	500/590	280	320	144/159
C125	125	125	230/290	530	590	300	360	169/178
D125	100	125	260/290	560	620	280	380	181/184
B200	200	200	230/290	440/530	500/590	280	380	174/188
C200	200	200	230/290	530	590	300	400	227/230

Vertical close coupled and horizontal long coupled dimensions are available upon request.

\*Approximate Weight (excluding motor)

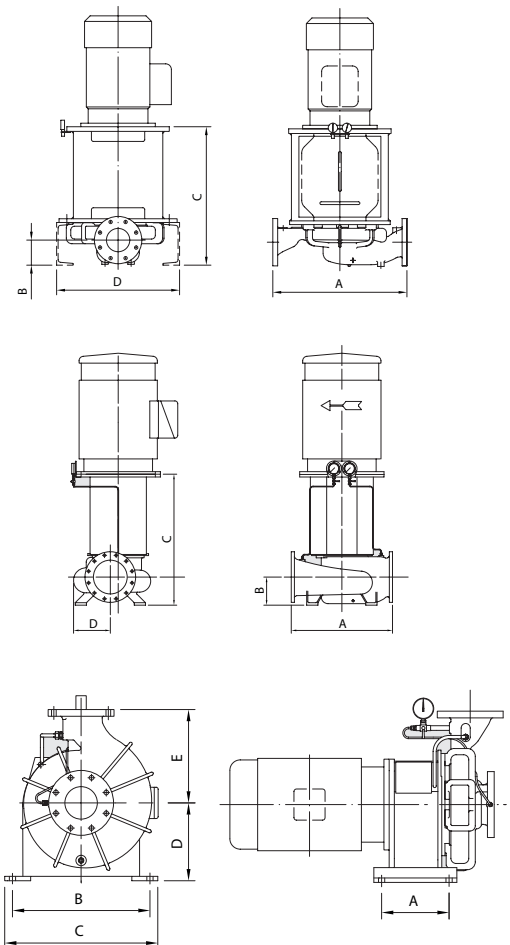

## Construction code

<b>BASIC PUMP SIZE</b>	<b>B200</b>	<b>PUMP BUILD</b>
Single Entry B80	<b>V</b>	C - Close-coupled to prime mover, no pump bearing
Single Entry C80		K - Close-coupled to prime mover, no pump bearing, steel mounting foot
Single Entry B125		D - Rigid spacer coupled to prime mover, product lubricated sleeve bearing
Single Entry C125		F - External roller bearings. Flexible spacer coupling to prime mover
Single Entry D125	<b>I</b>	X - External roller bearings. Bare shaft extension
Single Entry B200		O - Other special build not allocated individual code
Single Entry C200	<b>B</b>	<b>DRIVER OPTIONS</b>
Double Entry DB250		1 - Non Self-primed
Double Entry DB300		2 - Air Ejector Primed
Double Entry DB350	<b>2</b>	4 - Central Priming System
<b>SHAFT AXIS</b>		5 - Hand Operated Rotary Bladed Primer
V - Vertical		6 - Automatic Rotary Bladed Primer
H - Horizontal		8 - Separate Motor-driven Primer
<b>PUMP CASING OPTIONS</b>		0 - Other Special Priming Arrangements
I - Inline		
E - End Suction		

## Standard materials of construction (SW & FW)

Casing – Nickel Aluminium Bronze	Cover – Nickel Aluminium Bronze	Impeller – Aluminium Bronze	Shaft – Stainless Steel
----------------------------------	---------------------------------	-----------------------------	-------------------------

## Pump configuration

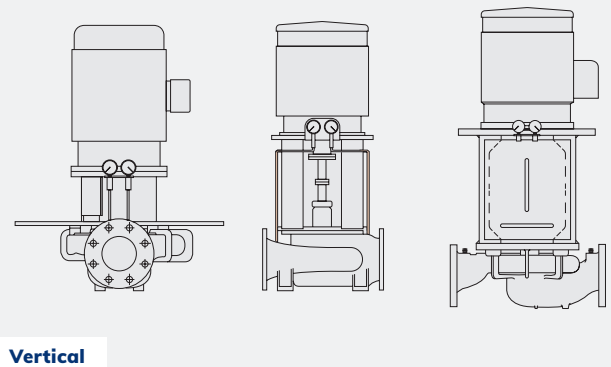
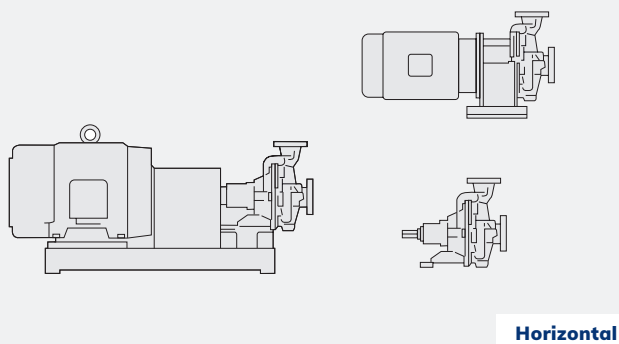

## Capacity range

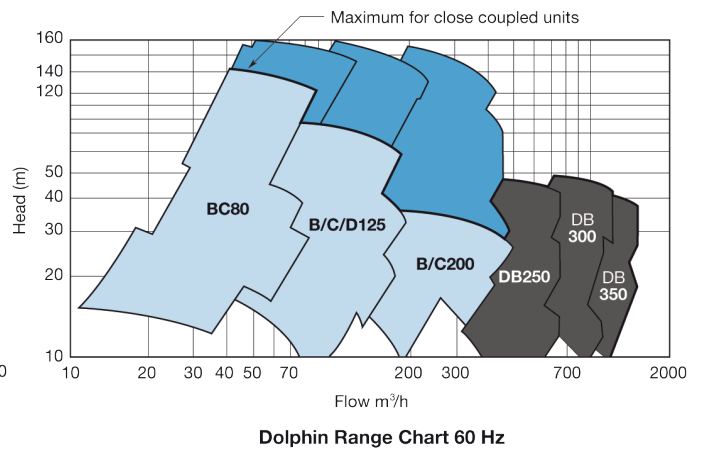
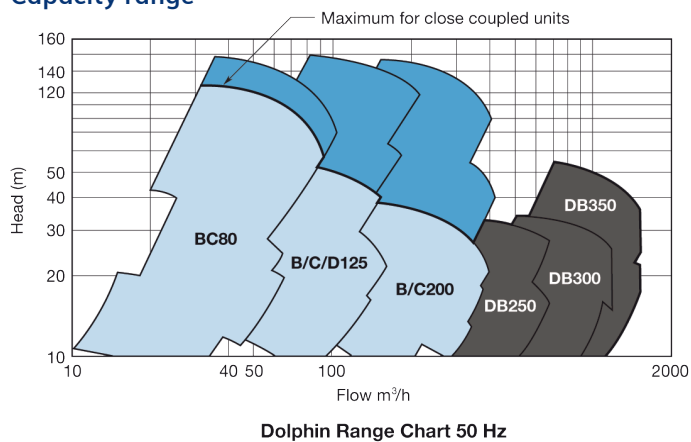

The manufacturers reserve the right to alter the specification and data to incorporate improvements in design. Certified drawings will be issued on request.

© All details copyright Hamworthy Pumps

Website: [www.hamworthy-pumps.com](http://www.hamworthy-pumps.com)

**Hamworthy Pumps Singapore Pte Ltd**  
 Tel: +65 6261 6066  
 Email: [sgpumpsales@hamworthy-pumps.com](mailto:sgpumpsales@hamworthy-pumps.com)

**Hamworthy Pumps UK Ltd**  
 Tel: +44 (0) 788 6851102  
 Email: [gbpumps@hamworthy-pumps.com](mailto:gbpumps@hamworthy-pumps.com)

 **Hamworthy Pumps**